

#105 "CUSH 'N' SEAL"®

Four-Fin Adhesive-Backed
Sound and Smoke/Fire Seal
and Weatherstripping

"Cush 'N' Seal"® by DHSI Operating STC 32

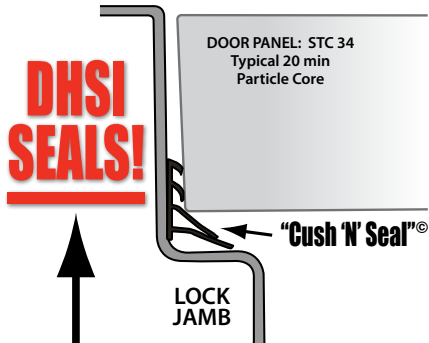

SAME OPENING:

"Teardrop" by others Operating STC 24

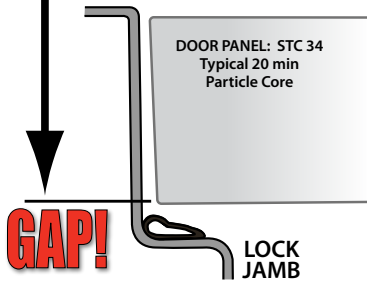

Teardrop doesn't work!

HINGE JAMB:

"Cush 'N' Seal"® by DHSI Operating STC 32



Is Sound A Problem?

Highest Field Operable STC Ratings

"Cush 'N' Seal"® Frame Seals

- **#105** Four fins have the highest field STC Ratings in the industry for standard 20 or 90 minute Guest Entry or Connecting Room Doors.
- **#105-3HJ** Three-fin seal option. The only seal that does not create bind on full-mortise continuous hinges. Used on hinge jamb only.
- Warranted to block light and sound!
- ★ Only DHSI knows STC Ratings are only as practical as the seals and flooring/transition details. Ask for DHSI comparative STC testing of higher rated openings.



#105 "Cush 'N' Seal"
Standard Profile



#105-3HJ
Custom Profile



**Highest STC
Field Verified**

**Meets ADA transition, NFPA 101 Self Closing and
NFPA 80 2007 Fire Code Requirements**

Why DHSI Works:

- Warp and Out-of-Plumb don't affect DHSI Frame Seals. Self compensating for warp, thermal bow, and out of plumb.
- Others can not compensate! **GAP = Light, sound and smoke!**
- ★ **Adhesive warranted for life of the installation at interior**

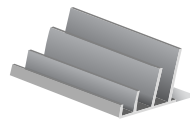

#105 "Cush 'N' Seal"®
x opening size (3'-0" x 7'-0", 6'-0" x 8'-0", etc)

Available in sets of 3, 4, 7 and 8 foot lengths

Color Choices: Off-White, Dark Brown and Black

Patents #5,577,349, #6,058,654, #6,266,924, #6,381,905, #8,209,909, #9,388,629 and Patents Pending

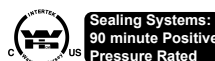

meets UL 1784, UL10C,
NFPA 80 and NFPA 101

**ACTIVE
LINK**

How sealing affects security: online at <http://dhsi-seal.com/qa.htm>

2

DHSI • DOOR AND HARDWARE SYSTEMS, INC.

17 Silver St., Rochester, NY 14611 T: (585) 235-8543 F: (585) 235-0431 E: info@dhsi-seal.com W: dhsi-seal.com

CAT-02 08-01-16 copyright